

VIPER VCAM SERIES IP CAMERAS

Adding a Wireless Access Point in a Barn or Shop

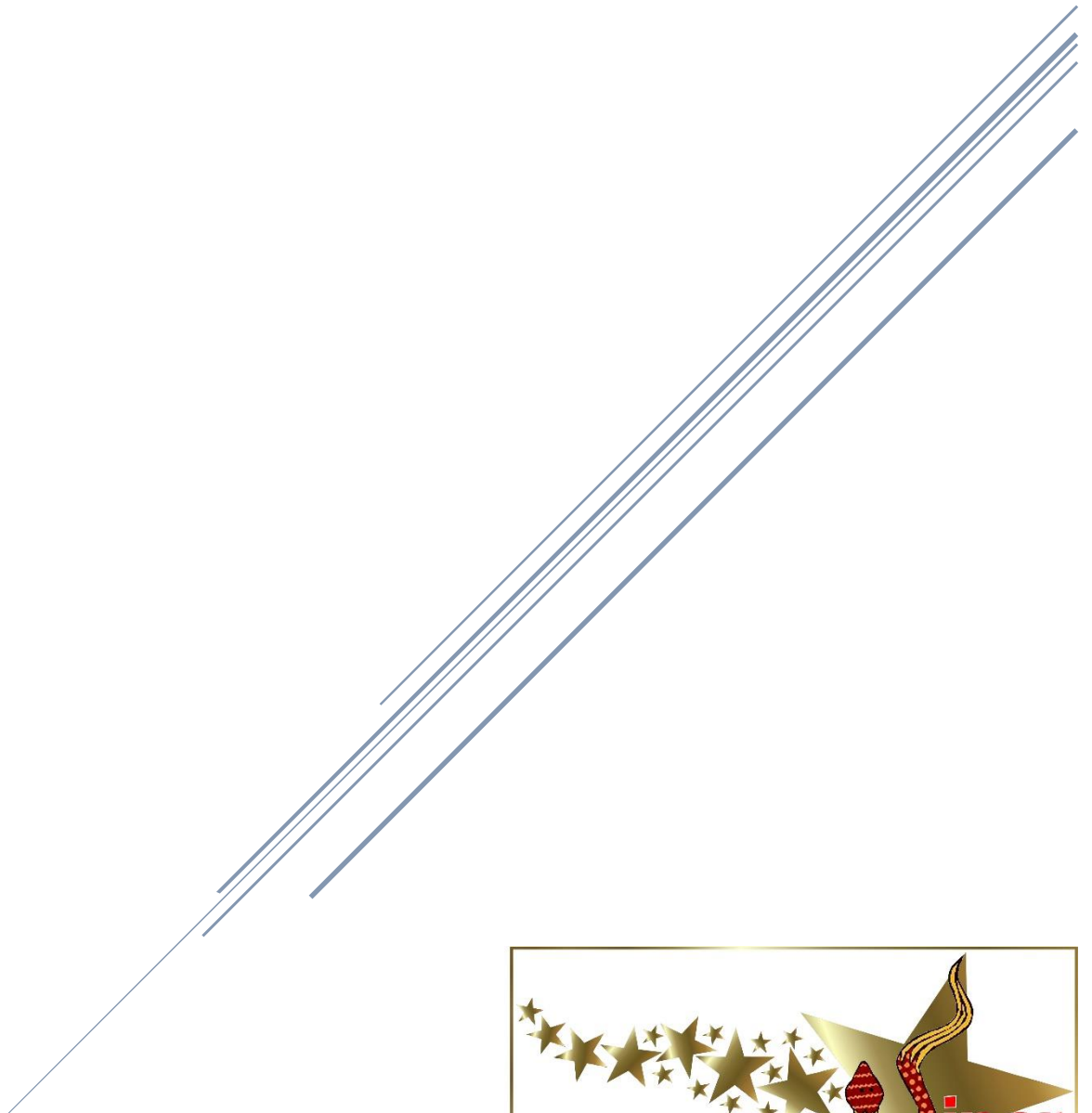

Installing the Wireless Master Bridge

Congratulations on adding an optional wireless access point (WAP) to your barn or shop! Viper's WAP will broadcast a powerful Wi-Fi signal in your barn/shop, fed from your house's internet provider, using the same rock-solid wireless link that your cameras use.

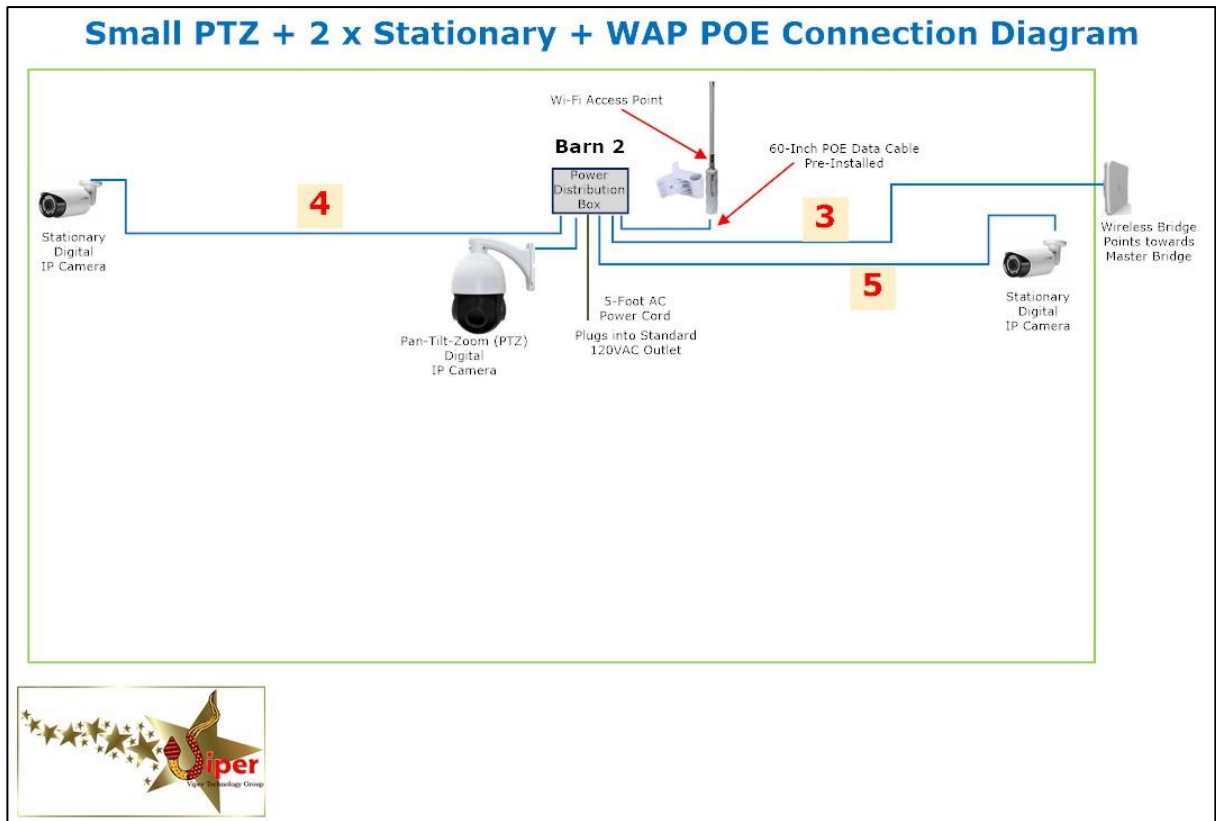

The required Ethernet data cable to connect the WAP to the power distribution box has been installed into the power distribution box for you, so all you need to do is assemble the WAP, mount it to a wall or joist, and plug it in.



Use the included screw-on black cable clips to fasten cables to the house/buildings.

NEVER Use standard T50 staples (or similar) to fasten any network cable. Damage **WILL** occur, often rendering the cable useless. If you wish to staple, use a cable stapler with correct rounded top cable staples, and use extreme caution. We recommend plastic electrical straps or nail-in cable only.



The WAP **MUST** be installed so the cable connecting to it exits **DOWNWARD**. Mounting the WAP so the cable exits sideways or up will result in your system functioning poorly or not at all

1. Wireless Access Point (WAP) components:

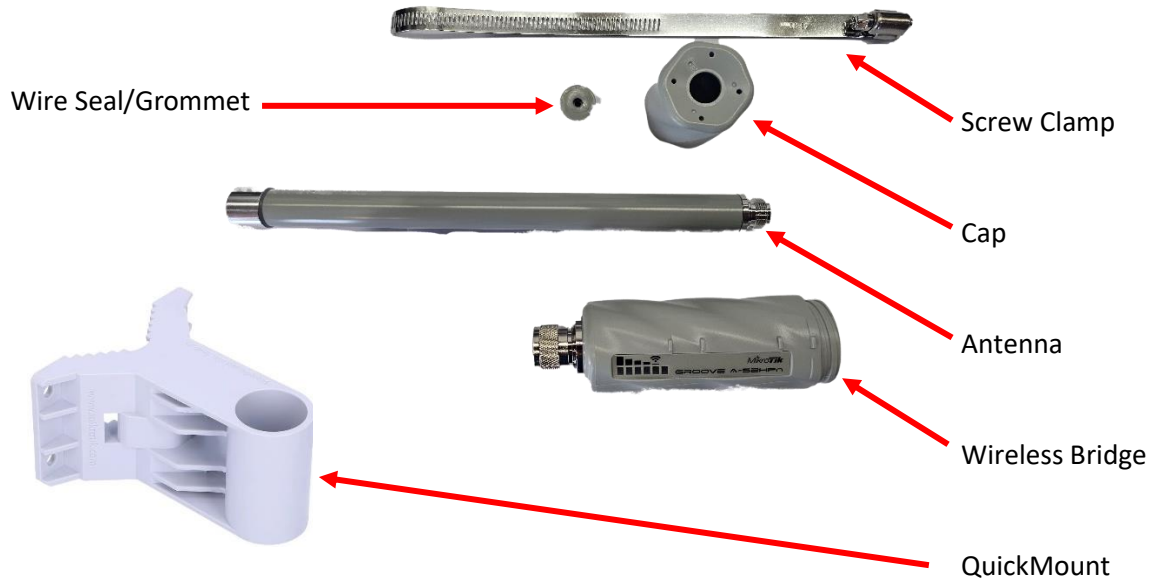

2. Install the antenna on the WAP. Screw the included 8dbi antenna onto the female threads of the Wireless Master Bridge. Tighten until **SNUG** – **DO NOT OVER-TIGHTEN, AS YOU CAN EASILY BREAK THE WAP.**



3. Connect the data cable to the WAP:

- a. Remove the rubber grommet from the bridge cap. Feed the data cable through the hole in the bridge cap and firmly plug it into the Master Wireless Bridge.

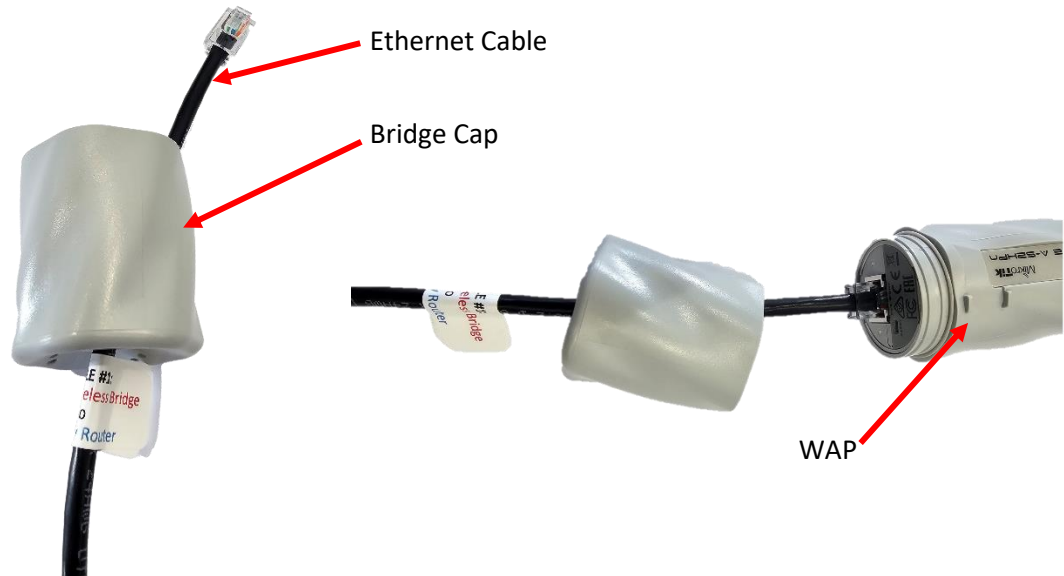

- b. Screw cap onto bridge and tighten snug. Again, don't over-tighten in case you ever need to remove the cap in the future.



- c. Place the rubber grommet over the cable (the grommet is split) and slide up to the cover. Carefully and fully tuck the grommet into the bridge cap, creating a weatherproof seal.



4. Attach the WAP to the QuickMount

- a. Use screw clamp (included with bridge) to securely attach the WAP to the QuickMount. Coil up extra cable neatly (**DO NOT KINK**) and attach to the wall or QuickMount using wire ties, electrical tape, etc.

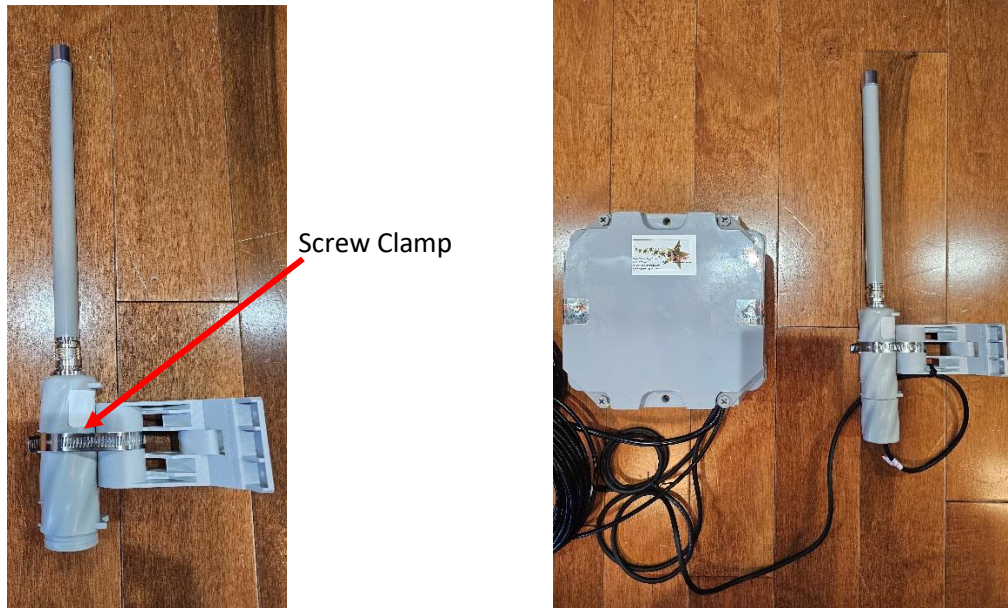

5. Mount the WAP and mount to a solid surface (wall or joist).



Be sure to leave a little slack in the cable before it enters into the WAP – if not, when the wire shrinks due to cold weather, it could disconnect the cable from the bridge.